

**A portable cellular device with a free
500MB data plan and LoRa®/LoRaWAN®
as fallback connectivity**



**Monogoto™ SIM card comes with worldwide coverage
(if Cat M1 and Cat NB2 is supported)**

WisTrio

Link.ONE

**Build your WisBlock solution
with combined cellular and
LoRa®/LoRaWAN® connectivity**

Link.ONE is a modular device built with WisBlock modules. It combines a cellular modem for LTE Cat M1 and NB-IoT with a WisBlock Core module that provides LoRa®, LoRaWAN® and BLE connectivity. The cellular modem has, in addition, a GNSS location-tracking capability



- Nordic nRF52840 MCU Semtech SX1262 LoRa® transceiver
- Quectel BG77 LTE Cat M1 & Cat NB2
- Monogoto™ SIM card
- Optional Unify Enclosure IP65
- 5-pin IP65 M8 connector for power supply
- Internal LoRa® & BLE antenna
- External LTE antenna



Contact Us

✉ inquiry@rakwireless.com

Follow Us



Discover More



Design your device with the flexibility of WisBlock modules

Global Cat M1 & Cat NB communication functionality



Select between cellular and LoRaWAN® communication

Affordable cellular connection cost with the Monogoto™ SIM card with worldwide coverage



Global SIM Card

Choose from different configuration options:

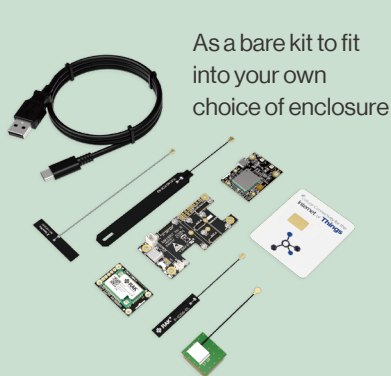

As a bare kit to fit into your own choice of enclosure



As a kit with IP65 enclosure and optional with backup battery

Extend the Link.ONE with a wide selection of WisBlock sensors to build the device you need for your application



Write your own application for the Link.ONE with the power of the RUI3 API

Link.ONE is supported by **RUI3** API, which allows you to

create low-power applications with **LoRa® / LoRaWAN®** connectivity with ease

Alternatively, you can choose the **Arduino Open Source BSP**

Use our example codes to setup your cellular connectivity easily



TCP/IP connection



HTTP/HTTPS API



MQTT connection



AWS MQTT connection



Location tracking